

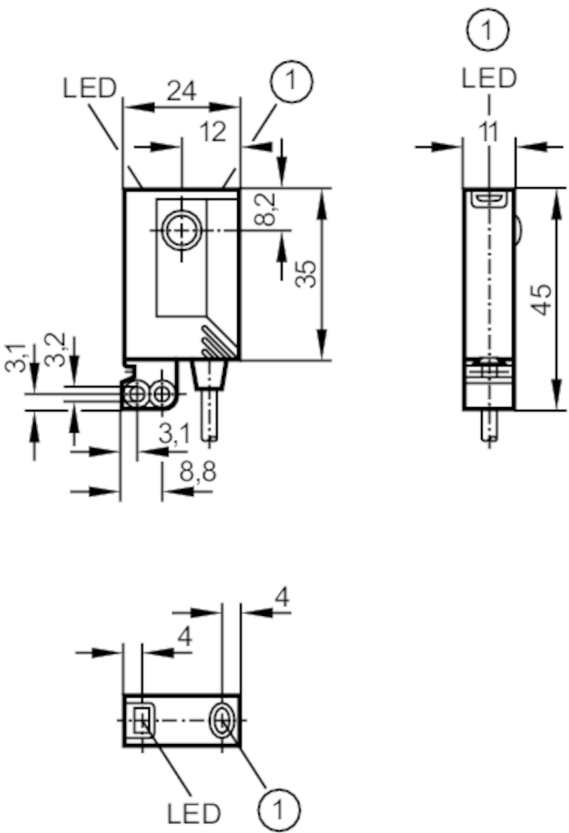

Through-beam sensor transmitter

OJS-00KG/FO



1 pushbutton without function



Product characteristics		
Type of light		red light
Housing		rectangular
Application		
Function principle		Through-beam sensor
Electrical data		
Operating voltage	[V]	10...30 DC
Current consumption	[mA]	< 19
Protection class		III
Reverse polarity protection		yes
Type of light		red light
Wave length	[nm]	660
Outputs		
Overload protection		yes
Detection zone		
Transmitter / receiver		transmitter
Range	[m]	< 10
Max. light spot diameter	[mm]	1000

OJ5011



Through-beam sensor transmitter

OJS-00KG/FO

Light spot dimensions refer to _____ at maximum range

Operating conditions

Ambient temperature [°C] _____ -25...60

Protection _____ IP 67

Tests / approvals

EMC _____ EN 60947-5-2

MTTF [years] _____ 1773

Mechanical data

Weight [g] _____ 71.5

Housing _____ rectangular

Dimensions [mm] _____ 35 x 24 x 11

Materials _____ housing: ABS; fixture: diecast zinc; LED window: SEPS; pushbutton: SEPS

Lens material _____ glass

Lens alignment _____ front lens

Displays / operating elements

Display _____ operation _____ 1 x LED, green

Accessories

Items supplied _____ Basic clip: 1, E20964

_____ screws: 2 x M3 x 16

_____ spring washers: 2

_____ Nuts: 2

Remarks

Remarks _____ operating voltage "supply class 2" according to cULus

Pack quantity _____ 1 pcs.

Electrical connection

Cable: 2 m, PVC; 2 x 0.14 mm²

Connection

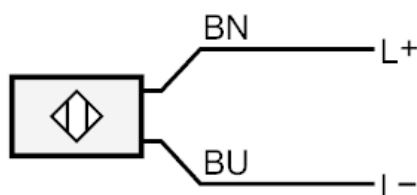

BN = Core colours :
brown
BU = blue