

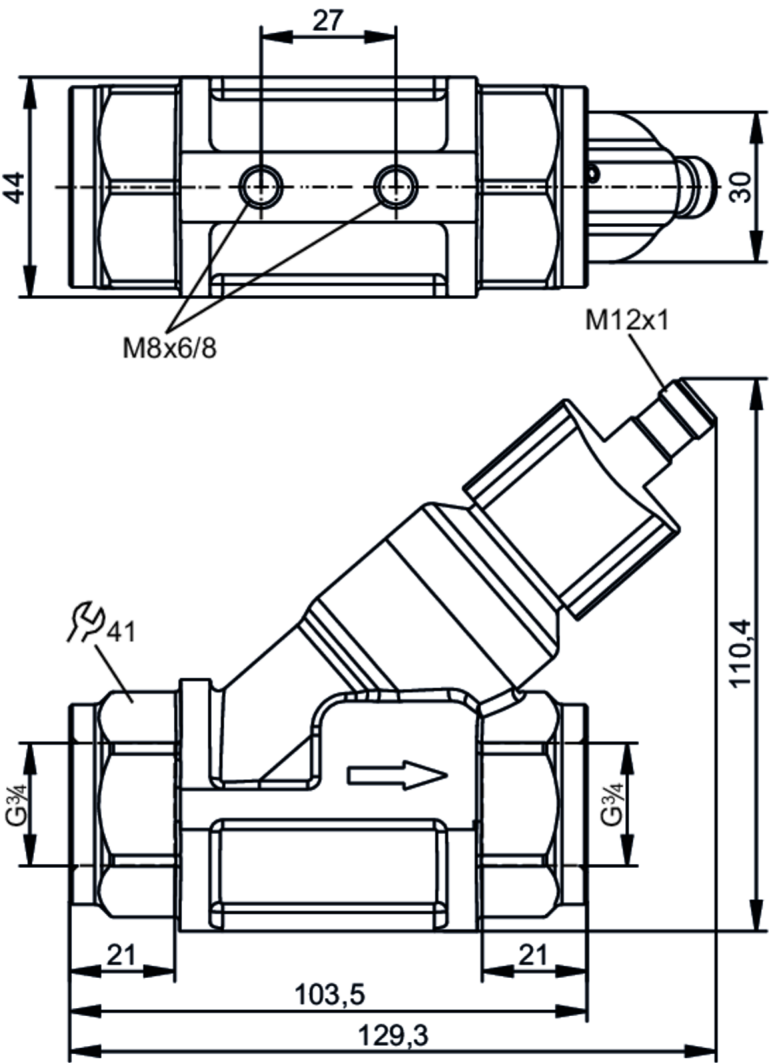

Flow transmitter with integrated backflow prevention

SBG34HF010KG/US

Please note the changed housing design!



| Product characteristics | | |
|-------------------------|---------|--|
| Measuring range | [l/min] | 4...100 |
| Process connection | | threaded connection G 3/4 |
| Application | | |
| Media | | Liquids; water; glycol solutions; coolants |
| Medium temperature | [°C] | -10...100 |
| Pressure rating | [bar] | 25 |
| Pressure rating | [MPa] | 2.5 |
| Electrical data | | |
| Operating voltage | [V] | 18...32 DC; (to SELV/PELV) |
| Current consumption | [mA] | < 35 |
| Protection class | | III |



Flow transmitter with integrated backflow prevention

SBG34HF010KG/US

| | |
|--|---|
| Reverse polarity protection | yes |
| Outputs | |
| Output signal | analogue signal |
| Analogue current output [mA] | 4...20 |
| Max. load [Ω] | 500 |
| Short-circuit protection | yes |
| Overload protection | yes |
| Measuring/setting range | |
| Measuring range [l/min] | 4...100 |
| Accuracy / deviations | |
| Repeatability [% of the final value] | 1 |
| Measuring error [% of the final value] | ± 5 |
| Response times | |
| Response time [s] | < 0.01 |
| Operating conditions | |
| Ambient temperature [°C] | 0...60 |
| Storage temperature [°C] | -15...80 |
| Protection | IP 65; IP 67 |
| Tests / approvals | |
| EMC | DIN EN 61000-6-2 |
| | DIN EN 61000-6-3 |
| Shock resistance | DIN EN 60068-2-27 20 g (11 ms) |
| Vibration resistance | DIN EN 60068-2-6 5 g (10...2000 Hz) |
| MTTF [years] | 778 |
| Mechanical data | |
| Weight [g] | 1297.6 |
| Materials | brass chemically nickel-plated; PP; stainless steel (316L/1.4404); aluminium anodised; PA |
| Materials (wetted parts) | stainless steel (316 / 1.4401); brass; brass chemically nickel-plated; PP; PPS; O-ring: FKM |
| Process connection | threaded connection G 3/4 |
| Switching cycles mechanical | 10 million |
| Remarks | |
| Remarks | Recommendation Use 200 micron filtration |
| | All data refer to water (20 °C). |
| Notes | Please note the changed housing design! |
| Pack quantity | 1 pcs. |

Flow transmitter with integrated backflow prevention

SBG34HF010KG/US

Electrical connection

Connector: 1 x M12; coding: A



Connection

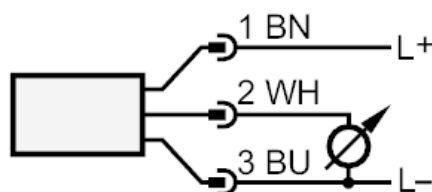

colours to DIN EN 60947-5-2

Core colours :

BN = brown
BU = blue
WH = white

Diagrams and graphs

Pressure loss

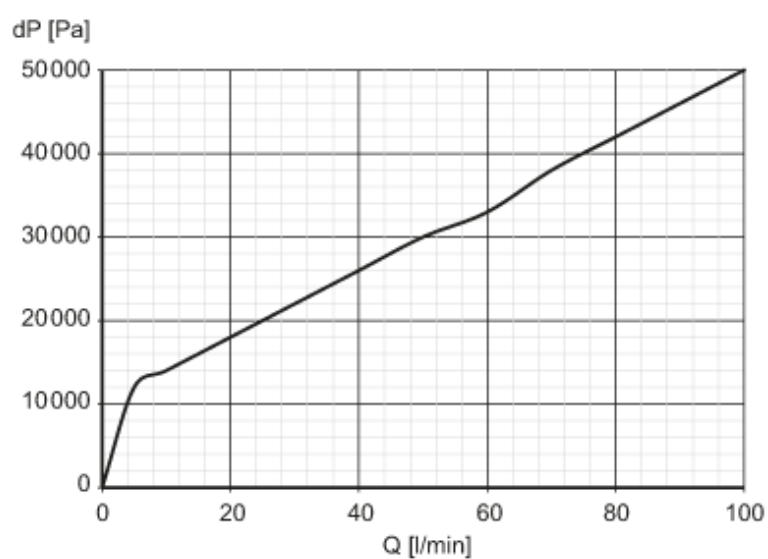

dP Pressure loss

Q volumetric flow quantity