

EC0732

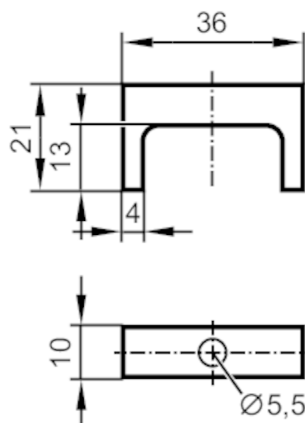

Mounting frame for graphic displays

Display/Mounting Set/10-12"



Application

Design for ecomatDisplay, CR1102 - 10", CR1204 - 12"

Mechanical data

Weight	[g]	141.45
Type of mounting		panel
Dimensions	[mm]	36 x 10 x 21
Material		Mounting frame: stainless steel (1.4301 / 304)

Accessories

Items supplied	Assembly angle: 4
	set screw: 4
	washers: 4
	Nuts: 4

Remarks

Pack quantity	1 pcs.
---------------	--------